

Sweet Buck Lake Cottage!



3706 Tiller Crescent



Something Special! Sweet lakefront cedar cottage enjoys western exposures over exclusive Buck Lake. Home features soaring vaulted ceilings, open plan kitchen/living area, a spacious loft and lower level master suite. Outside, a private dock provides access to the water's edge. Many mature plantings and a fenced garden complete this pretty picture. Desirable setting at the end of a very quiet street. This special offering includes the rare opportunity to acquire the neighbouring property which boasts a spacious garage/workshop and a self-contained bachelor studio with its own private dock. Create your family legacy!! Vendor prefers to sell together. Serviced by municipal water and sewer. Age of dwellings and measurements approximate; Buyer to verify if important.

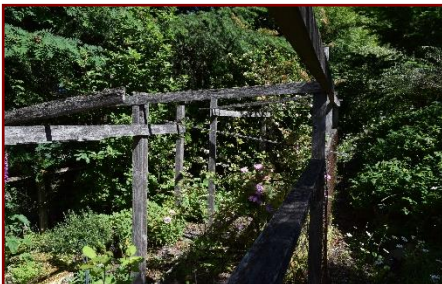

Property Details



3706 Tiller Crescent

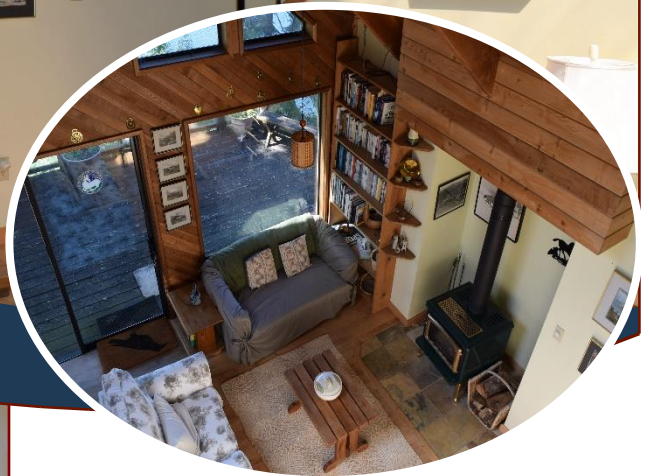

Year Built (est): 1980

Lot Acres: 0.17

Bedrooms: 3

Bathrooms: 2

Fin SqFt: 995

Unfin SqFt: 0

Bsmt: None

Water: City/municipal

Waste: Sewer

Driveway: None

Foundation:

Concrete Poured

Roof: Metal

Ext Fin: Wood

Fuel: Electric, Wood

Heat: Baseboard,
Wood

Lot Features:

- Lakefront
- Dock
- Water view
- Western exposure

Plot Plan and Aerial View

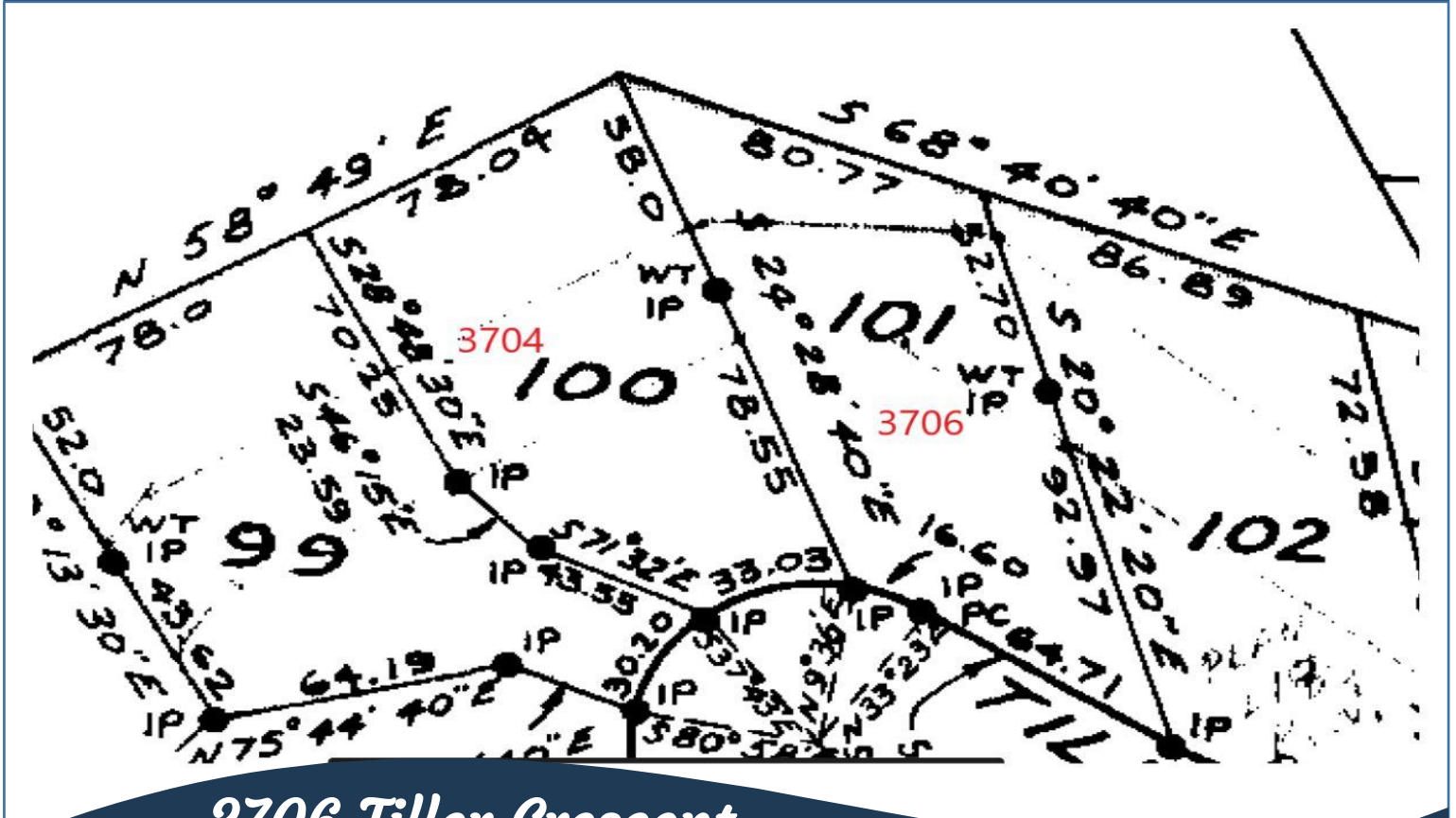

3706 Tiller Crescent



Hope Bay: 250-629-3166
Sidney: 250-656-5062
info@DocksideRealty.ca







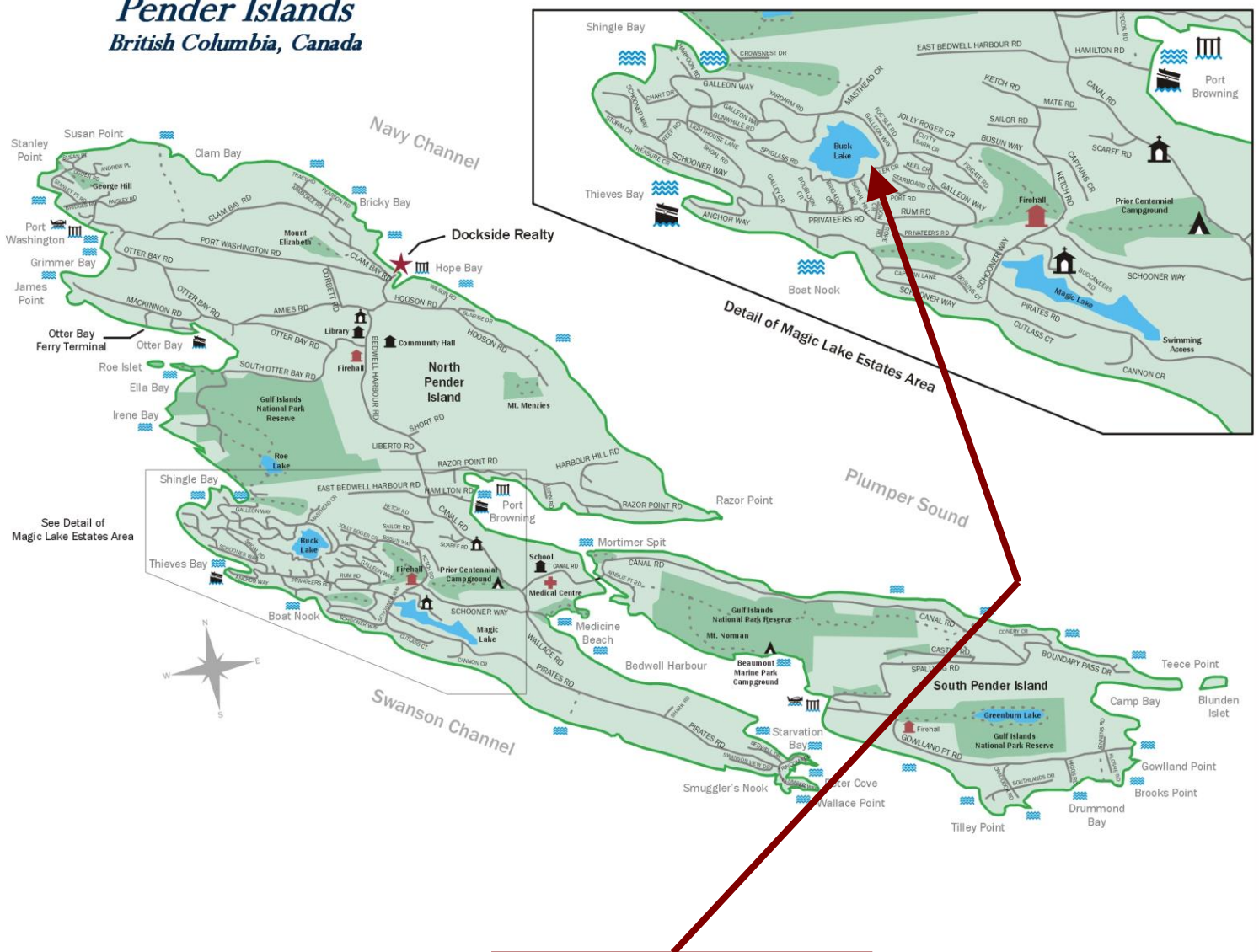



Driftwood: 250-629-3383
Saturna: 250-539-2121
www.DocksideRealty.ca

Pender Islands Map

Pender Islands British Columbia, Canada



Subject Property
3706 Tiller Crescent

-  Dockside Realty
-  Public Wharf
-  Boat Launch
-  Float Plane
-  Firehall
-  Medical Centre
-  Municipal
-  Place of Worship
-  Campground
-  Walking Trail
-  Ocean Access/View

Map courtesy of Dockside Realty. Design Copyright © 2012 Minsky Designs www.minskydesigns.com. All rights reserved.

DISCLAIMER: While every effort is made to provide reliable information, Dockside Realty Ltd. makes no representations or warranties as to the accuracy of this brochure.

All measurements are approximate and the buyer is responsible for verifying all data provided.



Hope Bay: 250-629-3166
Sidney: 250-656-5062
info@DocksideRealty.ca

Driftwood: 250-629-3383
Saturna: 250-539-2121
www.DocksideRealty.ca