

prepared exclusively for use by



250 629 3166  
[www.docksiderealty.ca](http://www.docksiderealty.ca)

McKinnon Road, Pender Island, BC  
 Main Floor (2750 sqft)  
 not to scale, all dimensions are approximate

MacLEAN ARCHITECTURE Inc.  
 Andrew MacLean 604 999 4381  
[inbox@macleanarchitecture.com](mailto:inbox@macleanarchitecture.com)  
 Pender Island, BC

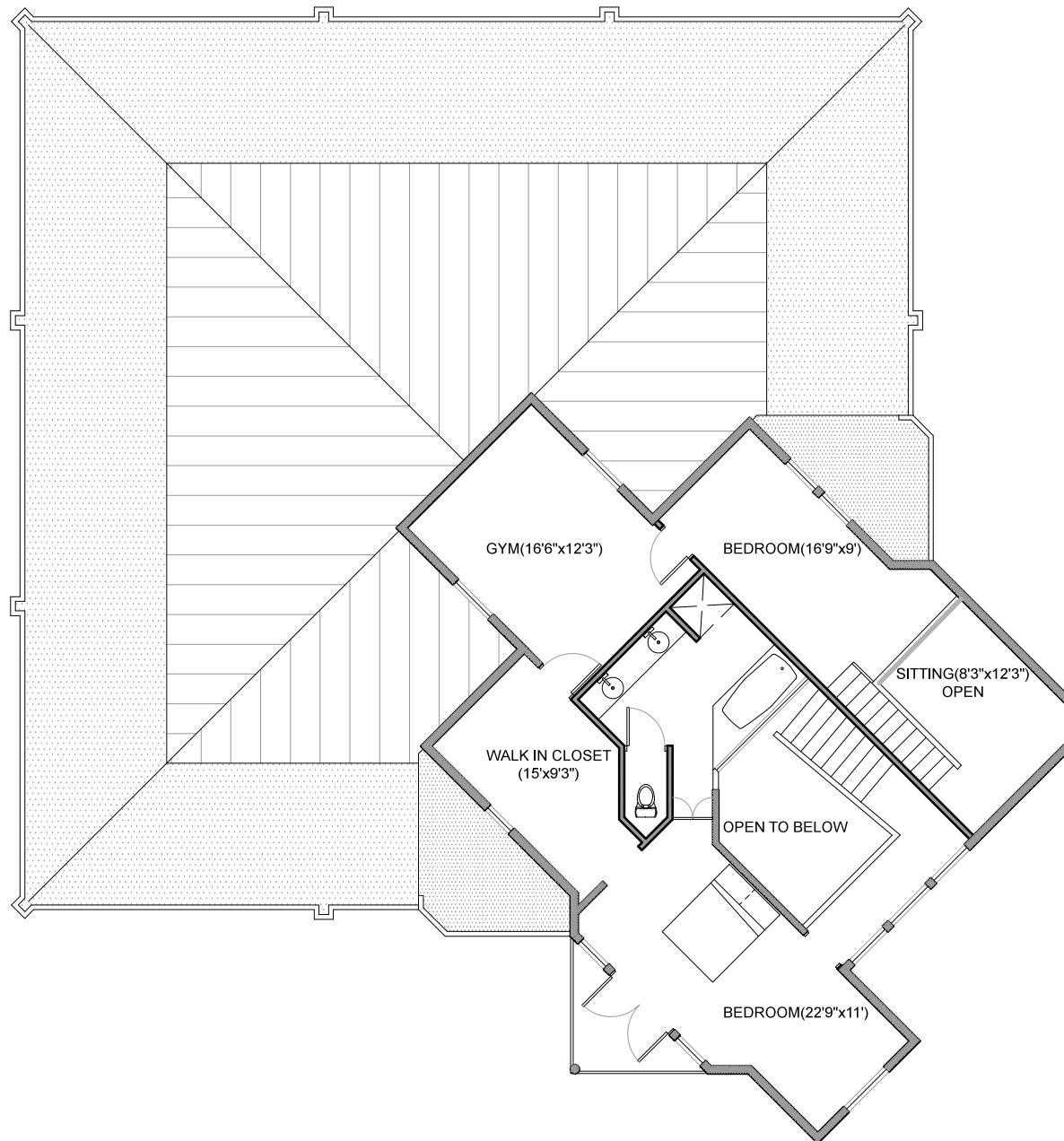

prepared exclusively for use by



250 629 3166  
[www.docksiderealty.ca](http://www.docksiderealty.ca)

McKinnon Road, Pender Island, BC  
 Main Floor (1340 sqft)  
 not to scale, all dimensions are approximate

MacLEAN ARCHITECTURE Inc.  
 Andrew MacLean 604 999 4381  
[inbox@macleanarchitecture.com](mailto:inbox@macleanarchitecture.com)  
 Pender Island, BC