

565 Dogwood St, Campbell River, BC

Main Floor Total Exterior Area 1090 sq ft
Total Interior Area 1031 sq ft



0 4 8
ft

PREPARED: Sep, 2019



White regions are excluded from total floor area. All room dimensions and floor areas must be considered approximate and are subject to independent verification. For method of measurement please see <https://youriguide.com/measure/>.

iGUIDE

565 Dogwood St, Campbell River, BC

Shop Total Exterior Area 324 sq ft
Total Interior Area 294 sq ft

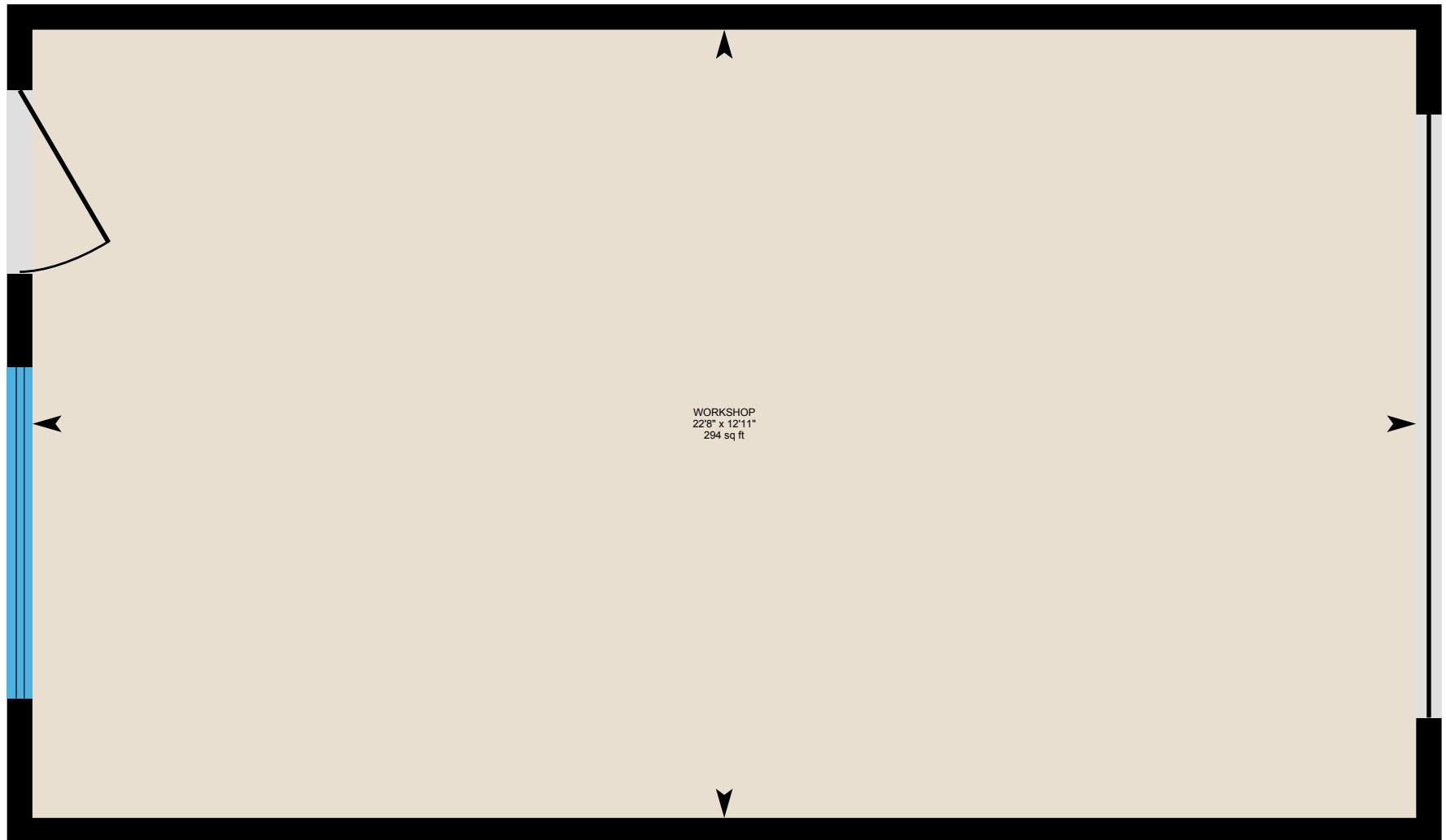

0 2 4 ft

PREPARED: Sep, 2019



White regions are excluded from total floor area. All room dimensions and floor areas must be considered approximate and are subject to independent verification. For method of measurement please see <https://youriguide.com/measure/>.

565 Dogwood St, Campbell River, BC

Property Details

Room Measurements

Only major rooms are listed. Some listed rooms may be excluded from total interior floor area (e.g. garage). Room dimensions are largest length and width; parts of room may be smaller. Room area is not always equal to product of length and width.

Main Building

MAIN FLOOR

4pc Bath: 5'5" x 9'1" | 43 sq ft
Bedroom: 12' x 12'3" | 127 sq ft
Bonus: 9'8" x 13'5" | 124 sq ft
Kitchen: 13'9" x 13'5" | 154 sq ft
Living: 11'1" x 26'9" | 296 sq ft
Master: 12'1" x 14'1" | 149 sq ft
Sun Room: 9' x 9'8" | 87 sq ft
Sun Room: 9'5" x 13'5" | 126 sq ft

Shop

SHOP

Workshop: 12'11" x 22'8" | 294 sq ft

Floor Area Information

For explanation of floor area calculations and method of measurement please see <https://youriguide.com/measure/>.

Main Building

MAIN FLOOR

Interior Area: 1031 sq ft
Perimeter Wall Length: 142 ft
Perimeter Wall Thickness: 5.0 in
Exterior Area: 1090 sq ft

Shop

SHOP

Interior Area: 294 sq ft
Perimeter Wall Length: 73 ft
Perimeter Wall Thickness: 5.0 in
Exterior Area: 324 sq ft

Total Above Grade Floor Area

Main Building Interior: 1031 sq ft
Main Building Exterior: 1090 sq ft

Shop Interior: 294 sq ft
Shop Exterior: 324 sq ft